



Gatwick Airport Northern Runway Project

Environmental Statement

Appendix 5.3.2: Code of Construction Practice Annex 6 – Outline Arboricultural and Vegetation Method Statement – Part 3 - Tracked Version

Book 5

VERSION: 4.0

DATE: JULY 2024

Application Document Ref: 5.3

PINS Reference Number: TR020005

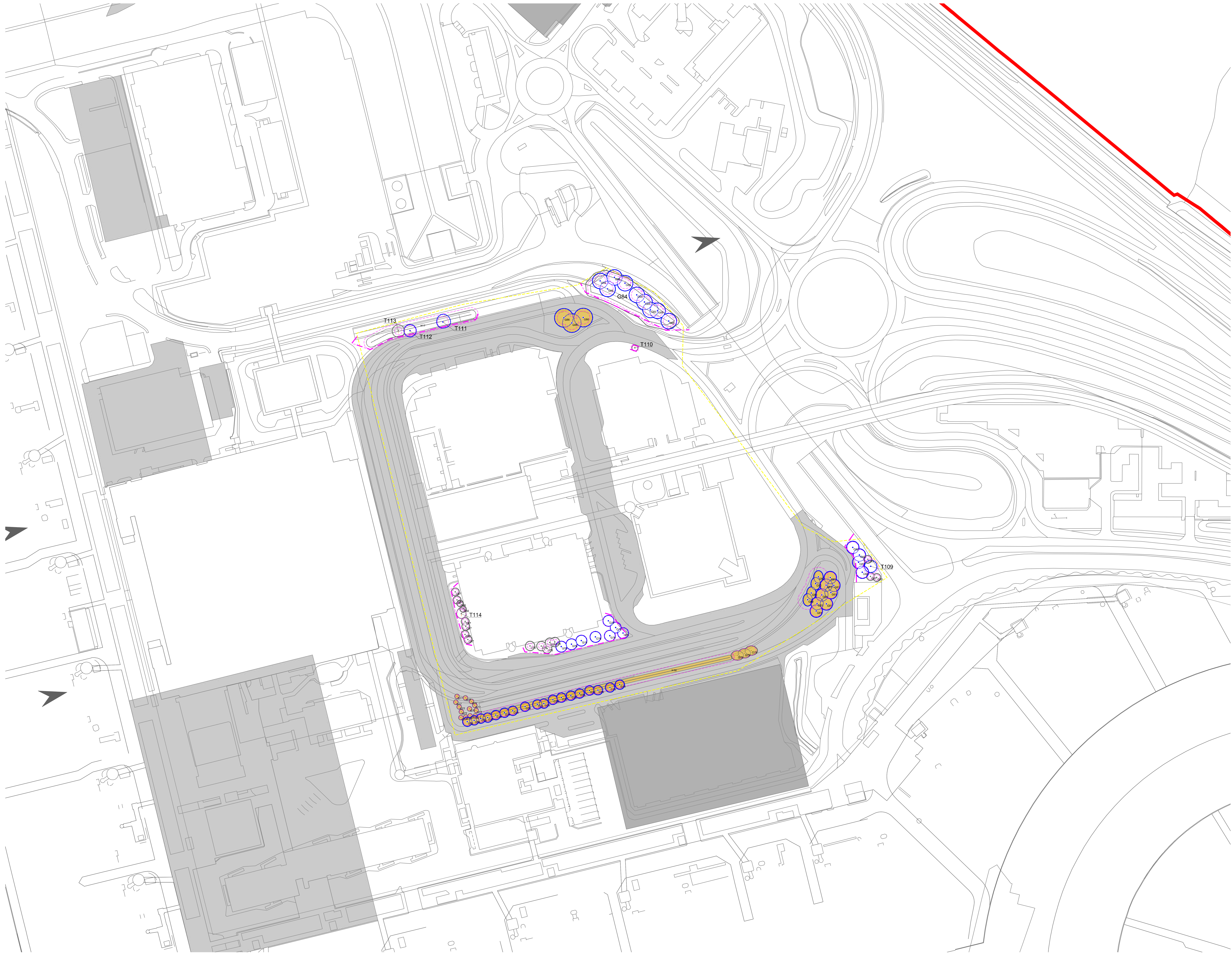

- Key**
- Site boundary
 - Survey boundary
 - Tree with numbered reference. Canopy extent and colour to match BS5837:2012 tree quality category as shown below.
 - Tree details estimate (inaccessible tree)
 - Tree in off site location
 - Tree group plotted with individual stem locations and numbered reference. Canopy extents coloured to match BS5837:2012 tree quality category as shown below
 - Tree or Vegetation group with numbered reference. Canopy extents coloured to match BS5837:2012 tree quality category as shown below and dashed line to show indicative stem line.
 - Hedge with numbered reference. Canopy extents and colour to match BS5837:2012 tree quality category as shown below and dashed line to show hedge centreline.
 - Woodland with numbered reference. Canopy extents coloured to match BS5837:2012 tree quality category as shown below and dashed line to show indicative tree line.
- BS 5837:2012 Tree Quality Categories - Table 1
- Category A - High quality
 - Category B - Moderate quality
 - Category C - Low quality
 - Category U - Unsuitable for retention
- Direction of first significant branch
 - Root protection area (RPA). Calculated in accordance with Section 4.6.
 - BS5837:2012
 - Vegetation tree buffer (15m from B) (as per standing advice produced by Forestry England and Natural England)
 - Tree protected by Tree Preservation Order.
 - Designated Ancient Woodland (as per Natural England ancient woodland inventory, via open data publication)
 - Ancient Woodland tree buffer (15m offset) (as per standing advice produced by Forestry England and Natural England)
 - Projected tree loss required for construction of the Project (worst case scenario)
 - Indicative Scheme Layout
 - Indicative temporary protective fence line in accordance with Section 6.2 - BS5837:2012. See below for example barriers.
 - Indicative secondary protective H16 Mesh fence line in accordance with Section 6.2 - BS5837:2012. See below for example barriers.
 - Indicative vegetation protective fence line; Design and location to be agreed by local council during detail design.

- NOTES:**
- Refer to ES Appendix A.10.1: Tree Survey Report and Ancillary Survey on behalf of the controller of Her Majesty's Stationery Office © Crown Copyright (2023). License number 0100031673, 100048492, 100048492.
 - The information contained in this document is for information only and is not intended to be used as a basis for any decision.
 - The information contained in this document is for information only and is not intended to be used as a basis for any decision.
 - The information contained in this document is for information only and is not intended to be used as a basis for any decision.
 - The information contained in this document is for information only and is not intended to be used as a basis for any decision.
-

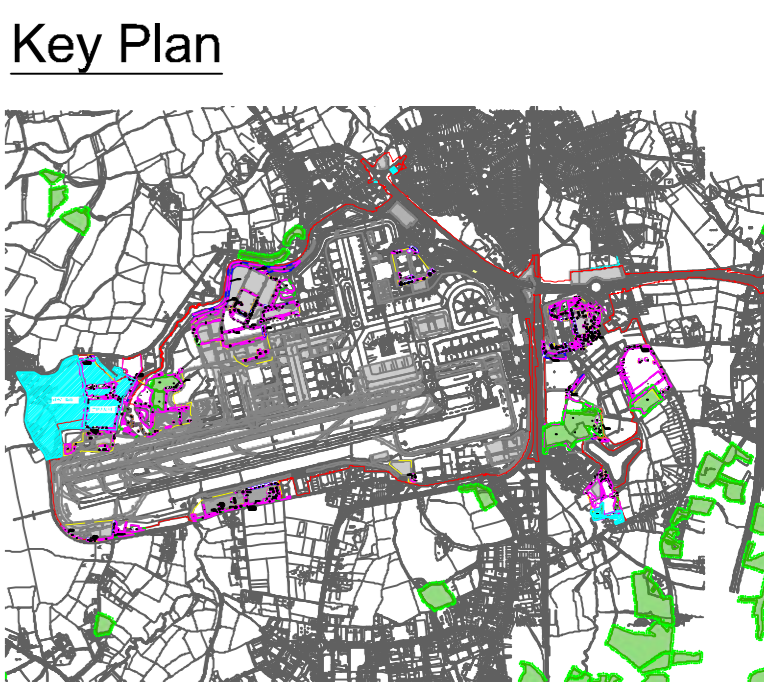

DOCUMENT

Environmental Statement

DRAWING TITLE

Airport Preliminary Tree Removal & Protection Plans Appendix 5.3.2 Annex 6 Sheet 6 of 13

DATE

June 2024

ORIENTATION 	DRAWING NO.	REVISION
	755	For ES Issue
	DRAWN BY	PIA / CHECKED BY
	RC	DC

SCALE @ A0

0m 25m 50m

Key

- Site boundary
- Survey boundary
- Tree with numbered reference. Canopy spread and coloured BS5837:2012 tree quality category as shown below.
 - = Tree details estimate (measurable tree)
 - = Tree in off site location
- Tree group plotted with individual stem locations and numbered reference. Canopy extents coloured to match BS5837:2012 tree quality category as shown below and dashed line to show indicative stem line.
- Hedge with numbered reference. Canopy extents coloured to match BS5837:2012 tree quality category as shown below and dashed line to show hedge centreline.
- Woodland with numbered reference. Canopy extents coloured to match BS5837:2012 tree quality category as shown below and dashed line to show indicative tree line.
- BS 5837:2012 Tree Quality Categories - Table 1**
 - Category A - High quality
 - Category B - Moderate quality
 - Category C - Low quality
 - Category U - Unsuitable for retention
- Direction of first significant branch
- Root protection area (RPA). Calculated in accordance with Section 4.6.
- BS5837:2012. Volcanic tree buffer (15 x 50m @) (as per standing advice produced by Forestry England and Natural England). Tree protected by Tree Preservation Order. Bracketted number relates to the TPO reference.
- Designated Ancient Woodland (as per Natural England ancient woodland inventory, via open data publication).
- Ancient Woodland tree buffer (15m offset) (as per standing advice produced by Forestry England and Natural England).
- Projected tree loss required for construction of the Project (worst case scenario).
- Indicative Scheme Layout
- Indicative temporary protective fence line in accordance with Section 6.2 - BS5837:2012. See below for example barriers.
- Indicative secondary protective H16 Mesh fence line in accordance with Section 6.2 - BS5837:2012. See below for example barriers.
- Indicative vegetation protective fence line. Design and location to be agreed by local council during detail design.

- NOTES:**
- Refer to ES Appendix A.10.1 - Tree Survey Report and Ancillary Survey on behalf of the controller of Her Majesty's Stationery Office
 - Survey undertaken in accordance with BS5837:2012
 - The quality of measurements and assessments are in accordance with BS5837:2012 - Tree in Relation to design, demolition and construction
 - Survey undertaken in accordance with BS5837:2012

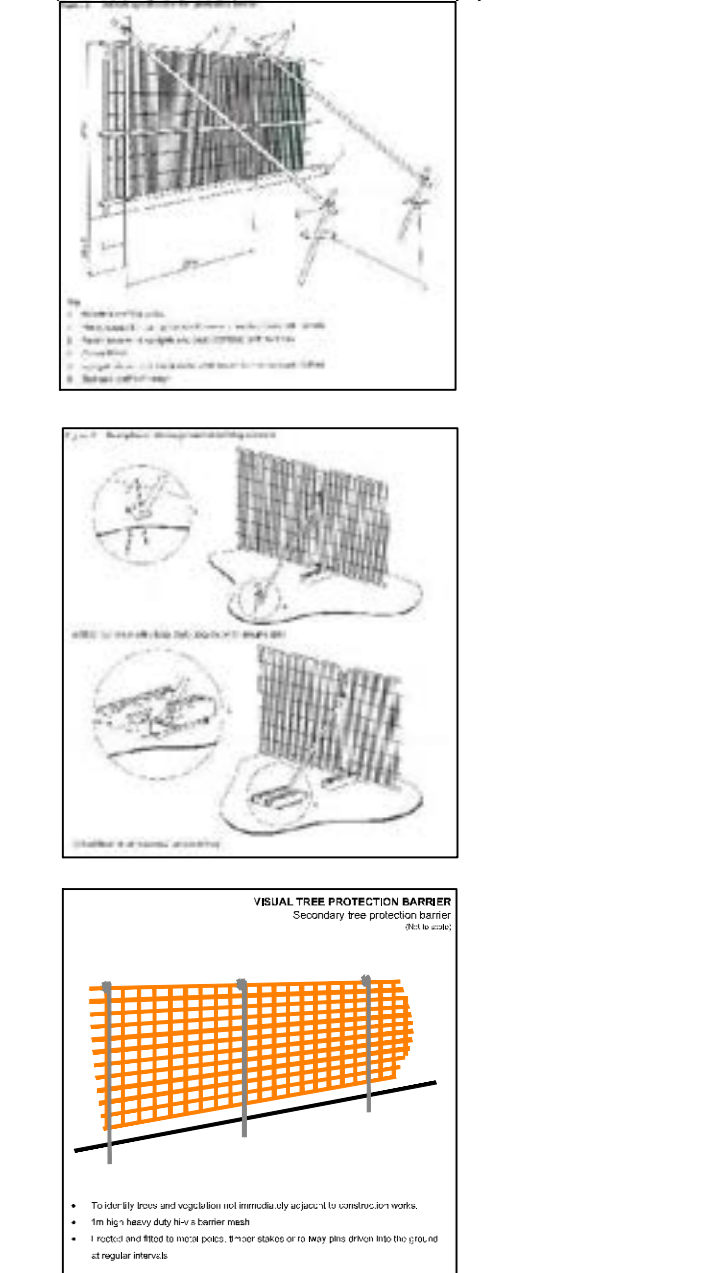

Key Plan

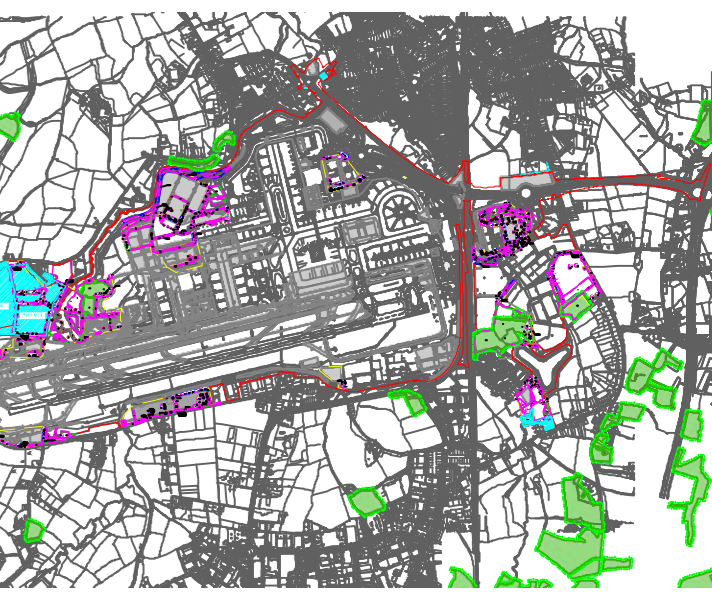

DOCUMENT

Environmental Statement

DRAWING TITLE
 Airport Preliminary Tree Removal & Protection Plans
 Appendix 5.3.2 Annex 6
 Sheet 7 of 13

DATE
 June 2024

ORIENTATION N	DRAWING NO.	REVISION
	756	For ES Issue
SCALE @ A0 0m 25m 50m	DRAWN BY	FM / CHECKED BY
	RC	DC

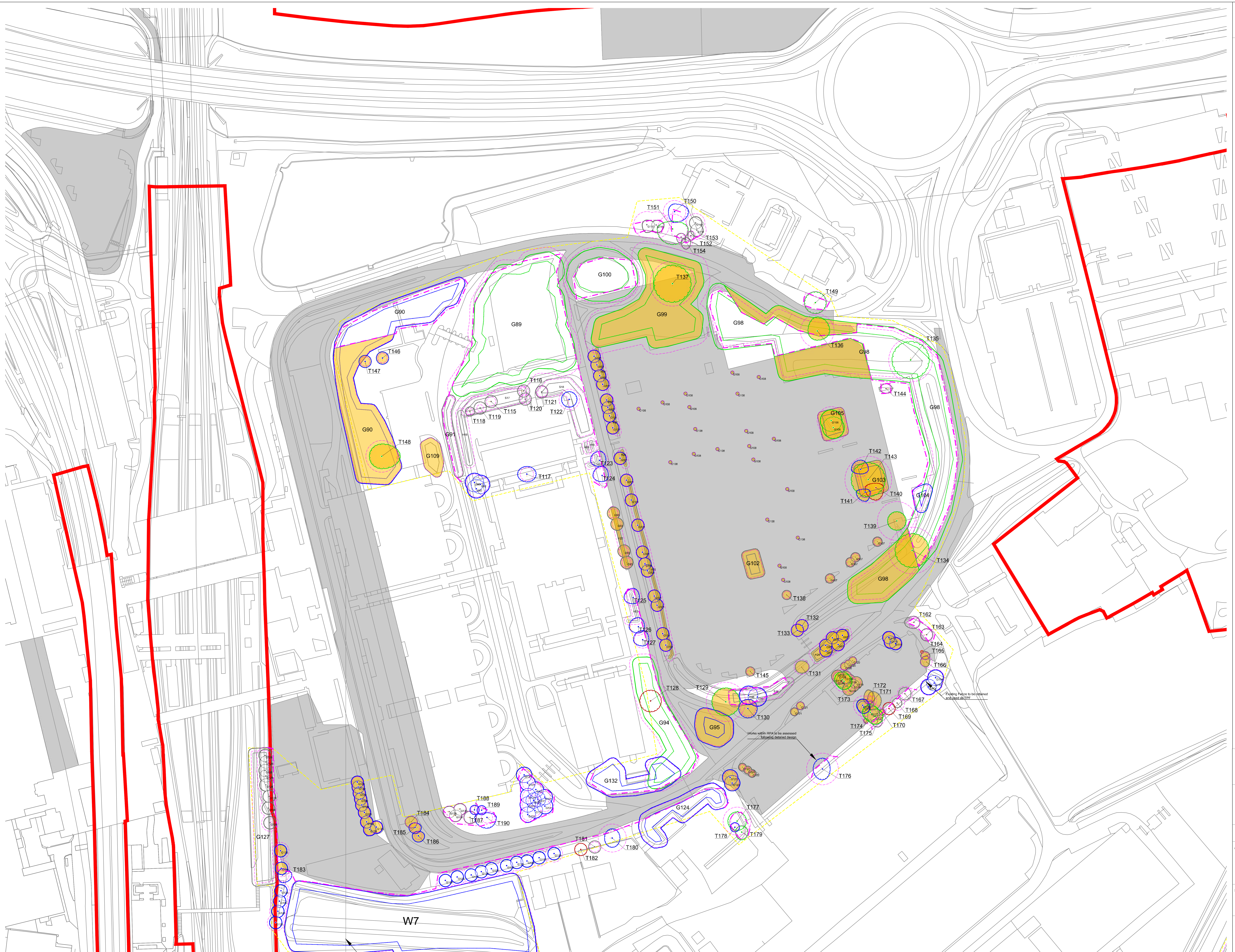

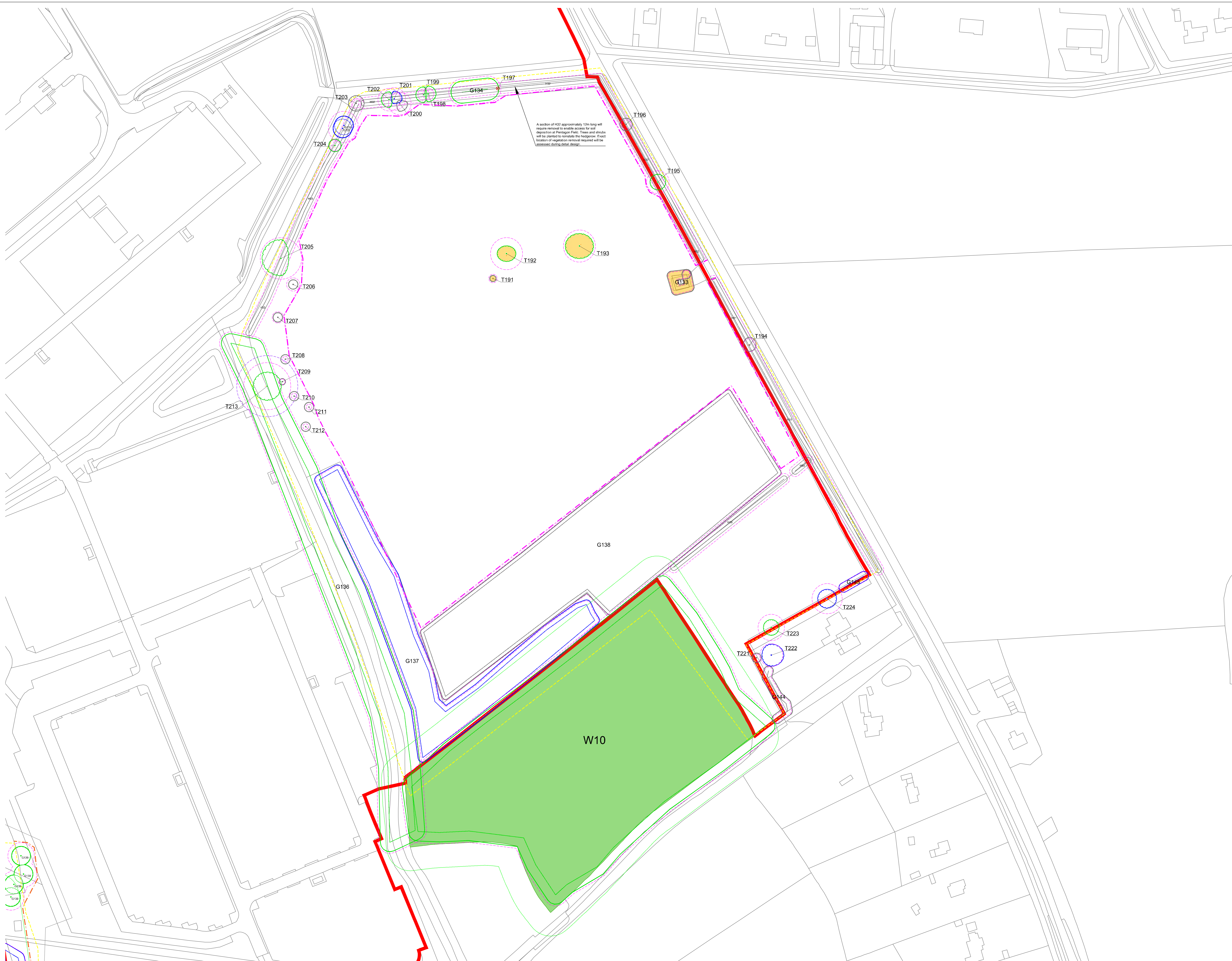

A section of HSD approximately 12m long will require removal to enable access for soil deposition at Penning Field. Trees and shrubs will be planted to re-establish the hedgerow. Exact location of vegetation removal required will be assessed during detail design.

Key

- Site boundary
- Survey boundary
- Tree with numbered reference. Canopy extent and coloured BS5837:2012 tree quality category as shown below.
 - Tree details estimate (inaccessible tree)
 - Tree on off site location
- Tree group plotted with individual stem locations and numbered reference. Canopy extents coloured to match BS5837:2012 tree quality category as shown below.
- Tree or vegetation group with numbered reference. Canopy extents coloured to match BS5837:2012 tree quality category as shown below and dashed line to show indicative stem line.
- Hedge with numbered reference. Canopy extents and coloured BS5837:2012 tree quality category as shown below and dashed line to show hedge centreline.
- Woodland with numbered reference. Canopy extents coloured to match BS5837:2012 tree quality category as shown below and dashed line to show indicative tree line.

BS 5837:2012 Tree Quality Categories - Table 1

- Category A - High quality
- Category B - Moderate quality
- Category C - Low quality
- Category U - Unsuitable for retention

- Direction of first significant branch
- Road protection area (RPA) Calculated in accordance with Section 4.6.1 BS5837:2012
- Vegetation tree buffer (15 x stem Ø) (as per standing advice produced by Forestry England and Natural England)
- Tree protected by Tree Preservation Order. Bracketted number relates to the TPO reference.
- Designated Ancient Woodland (as per Natural England ancient woodland inventory, via open data publication)
- Ancient Woodland tree buffer (15m offset) (as per standing advice produced by Forestry England and Natural England)
- Projected tree loss required for construction of the Project (worst case scenario)
- Indicative Scheme Layout
- Indicative temporary protective fence line in accordance with Section 6.2 BS5837:2012. See below for example barriers.
- Indicative secondary protective H/Vs Mesh fencing in accordance with Section 2 - BS5837:2012. See below for example barriers.
- Indicative vegetation protective fencing. Design and location to be agreed by local council during detail design.

NOTES:

- Refer to ES Appendix 6.10.1: Tree Survey Report and Ancillary
- Some areas are to be removed from the ground and are not intended as a permanent replacement.
- The final location and extent of the proposed scheme will be agreed with the local authority and the contractor.
- BS5837:2012 - Trees in Relation to Design, Construction and Construction
- Some areas are to be removed from the ground and are not intended as a permanent replacement.

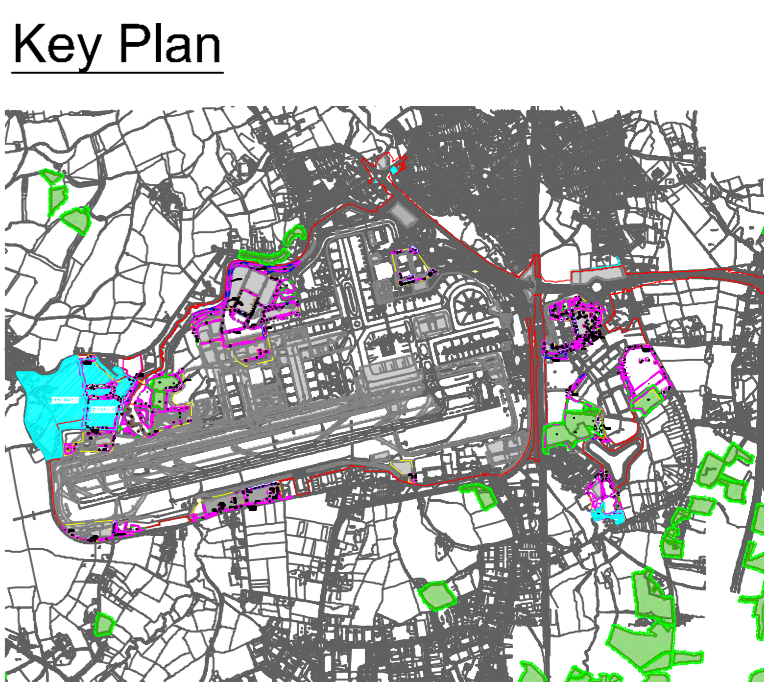
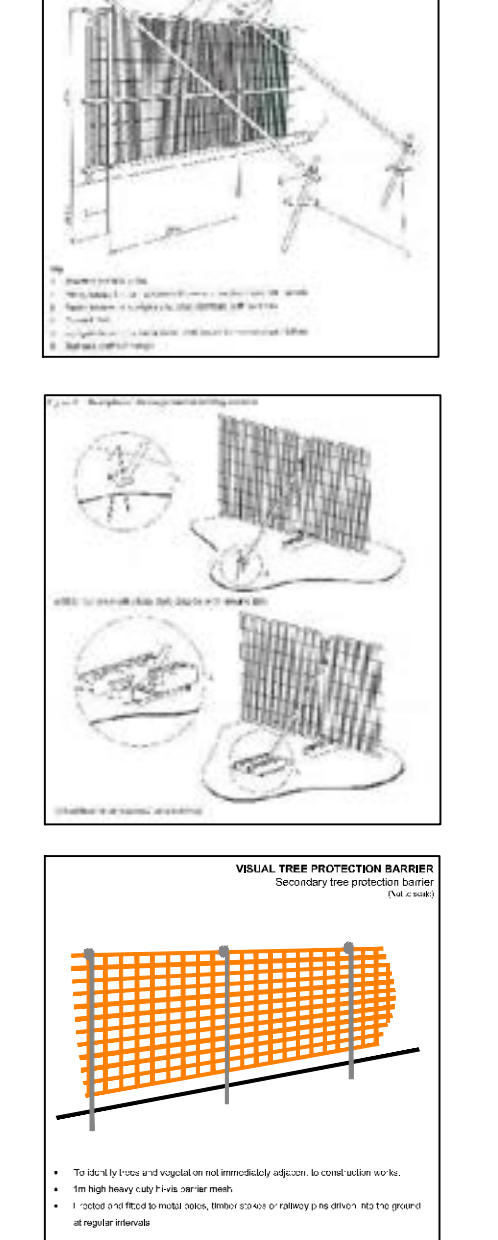

DOCUMENT

Environmental Statement

DRAWING TITLE

Airport Preliminary Tree Removal & Protection Plans
Appendix 5.3.2 Annex 6
Sheet 8 of 13

DATE

June 2024

ORIENTATION	DRAWING NO.	REVISION
	757	For ES Issue
	DRAWN BY	PIA / CHECKED BY
	RC	DC

SCALE @ A0

0m 25m 50m

Reproduced from Ordnance Survey map with the permission of Ordnance Survey on behalf of the controller of Her Majesty's Stationery Office © Crown Copyright (2023). Licence number 010031673, 10001998, 100048492.

© Copyright 2023 Gatwick Airport Limited. No part of this drawing is to be reproduced without prior permission of Gatwick Airport Limited.

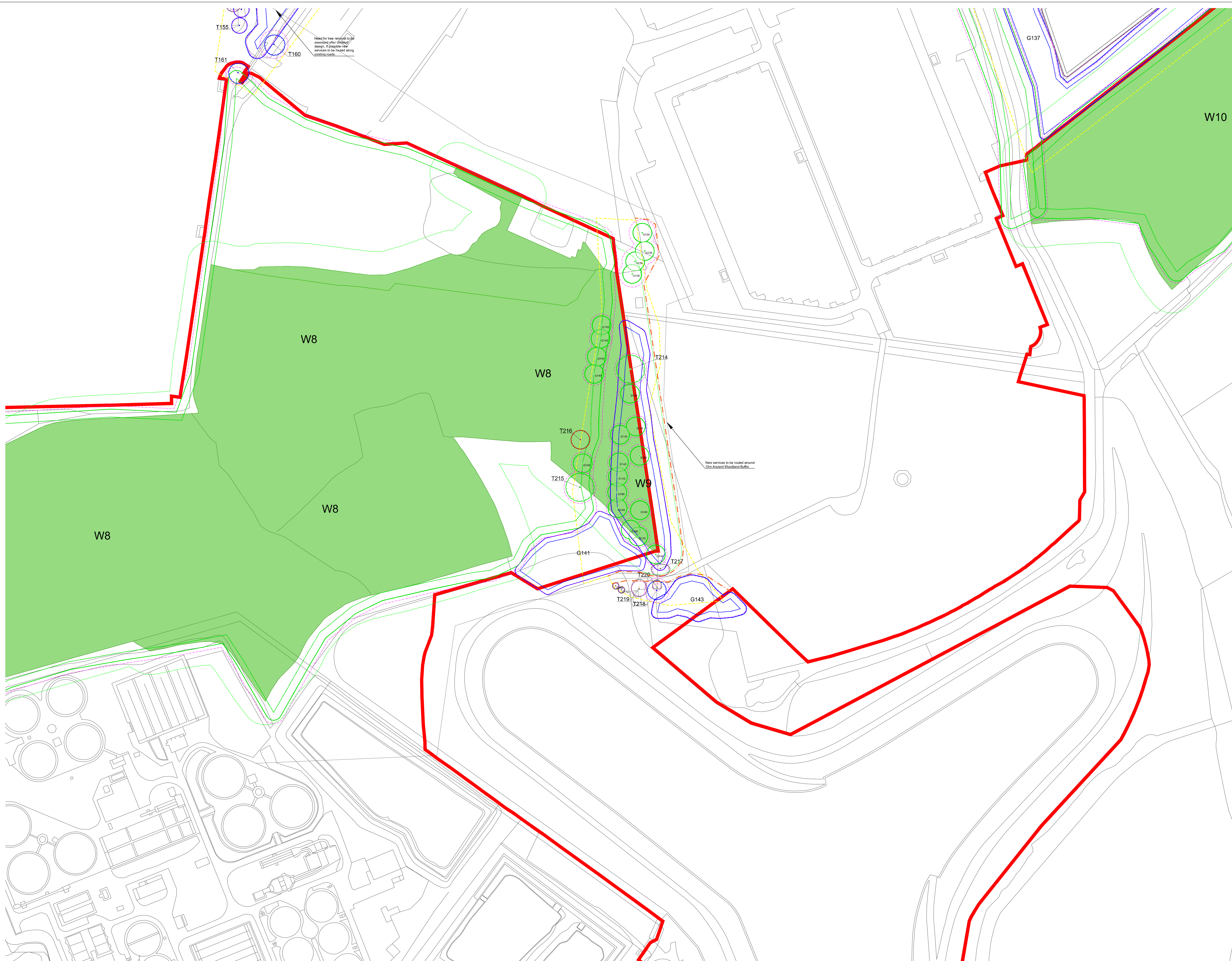

- Key**
- Site boundary.
 - Survey boundary.
 - Tree with numbered reference. Canopy spread and colour to match BS5837:2012 tree quality category as shown below.
 - = Tree details estimate (inaccessible tree)
 - = Tree in off site location
 - Tree group plotted with individual stem locations and numbered references. Canopy extents coloured to match BS5837:2012 tree quality category as shown below and dashed line to show indicative stem line.
 - Hedge with numbered reference. Canopy extents coloured to match BS5837:2012 tree quality category as shown below and dashed line to show hedge centreline.
 - Woodland with numbered reference. Canopy extents coloured to match BS5837:2012 tree quality category as shown below and dashed line to show indicative tree line.
- BS 5837:2012 Tree Quality Categories - Table 1
- Category A - High quality
 - Category B - Moderate quality
 - Category C - Low quality
 - Category U - Unsuitable for retention
- Direction of first significant branch
 - Road protection area (RPA). Calculated in accordance with Section 4.6 - BS5837:2012 (as per standing advice produced by Forestry England and Natural England)
 - Ancient Woodland tree buffer (15m offset) (as per standing advice produced by Forestry England and Natural England)
 - Projected tree loss required for construction of the Project (worst case scenario)
 - Indicative Scheme Layout
 - Indicative temporary protective fence/line in accordance with Section 6.2 - BS5837:2012. See below for example barriers.
 - Indicative secondary protective H/V Mesh fence/line in accordance with Section 6.2 - BS5837:2012. See below for example barriers.
 - Indicative vegetation protective fence/line; Design and location to be agreed by local council during detail design.

NOTES:

- Refer to ES Appendix 6.10.1: Tree Survey Report and Ancillary
- Some elements of this report have been removed from the project and are not intended as a full architectural record.
- The final architectural record will be updated to reflect any changes to the project during construction.
- Some elements of this report are subject to change and are not intended as a final architectural record.

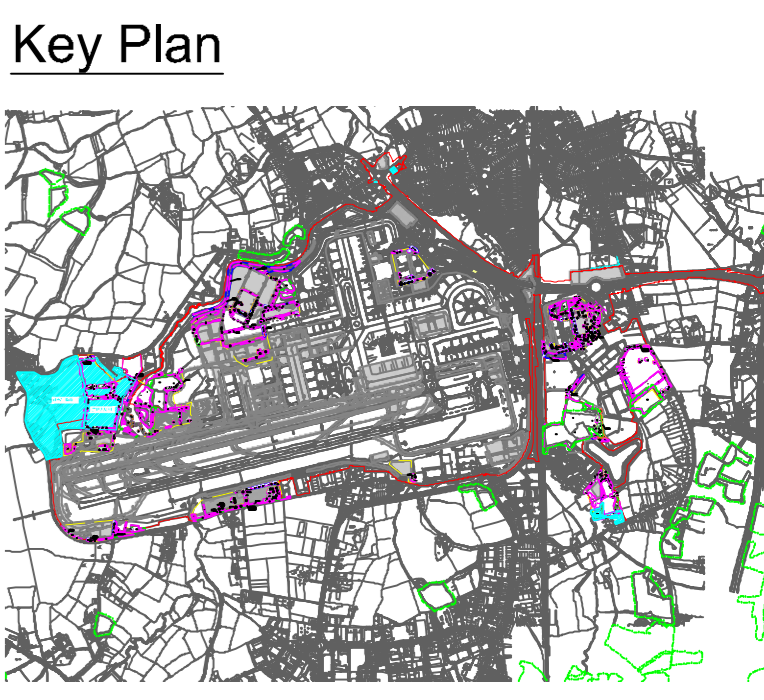
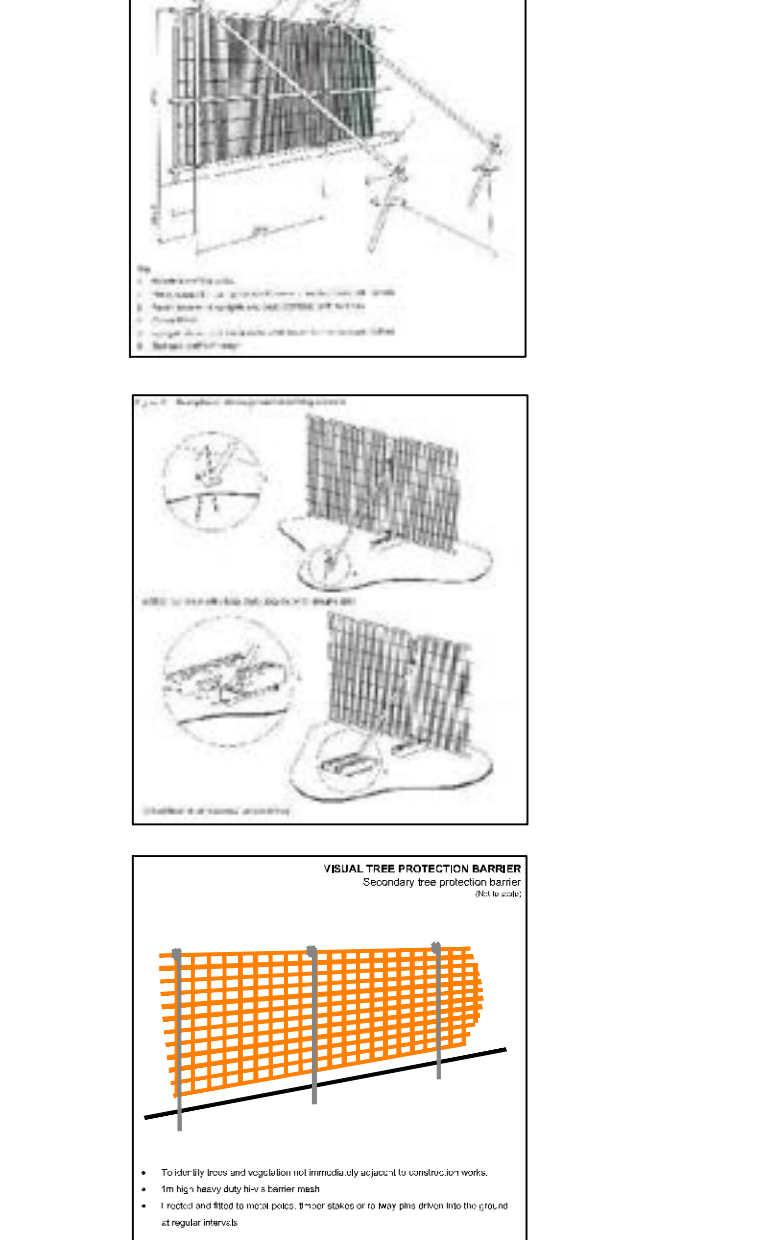

Environmental Statement

DRAWING TITLE
Airport Preliminary Tree Removal & Protection Plans
 Appendix 5.3.2 Annex 6
 Sheet 9 of 13

DATE
 June 2024

ORIENTATION N	DRAWING NO. 758	REVISION For ES Issue
	DRAWN BY RC	PIA / CHECKED BY DC

SCALE @ A0
 0m 25m 50m

Reproduced from Ordnance Survey map with the permission of Ordnance Survey on behalf of the controller of Her Majesty's Stationery Office © Crown Copyright (2023). Licence number 610031673, 100048492.
 © Copyright 2023 Gatwick Airport Limited. No part of this drawing is to be reproduced without prior permission of Gatwick Airport Limited.

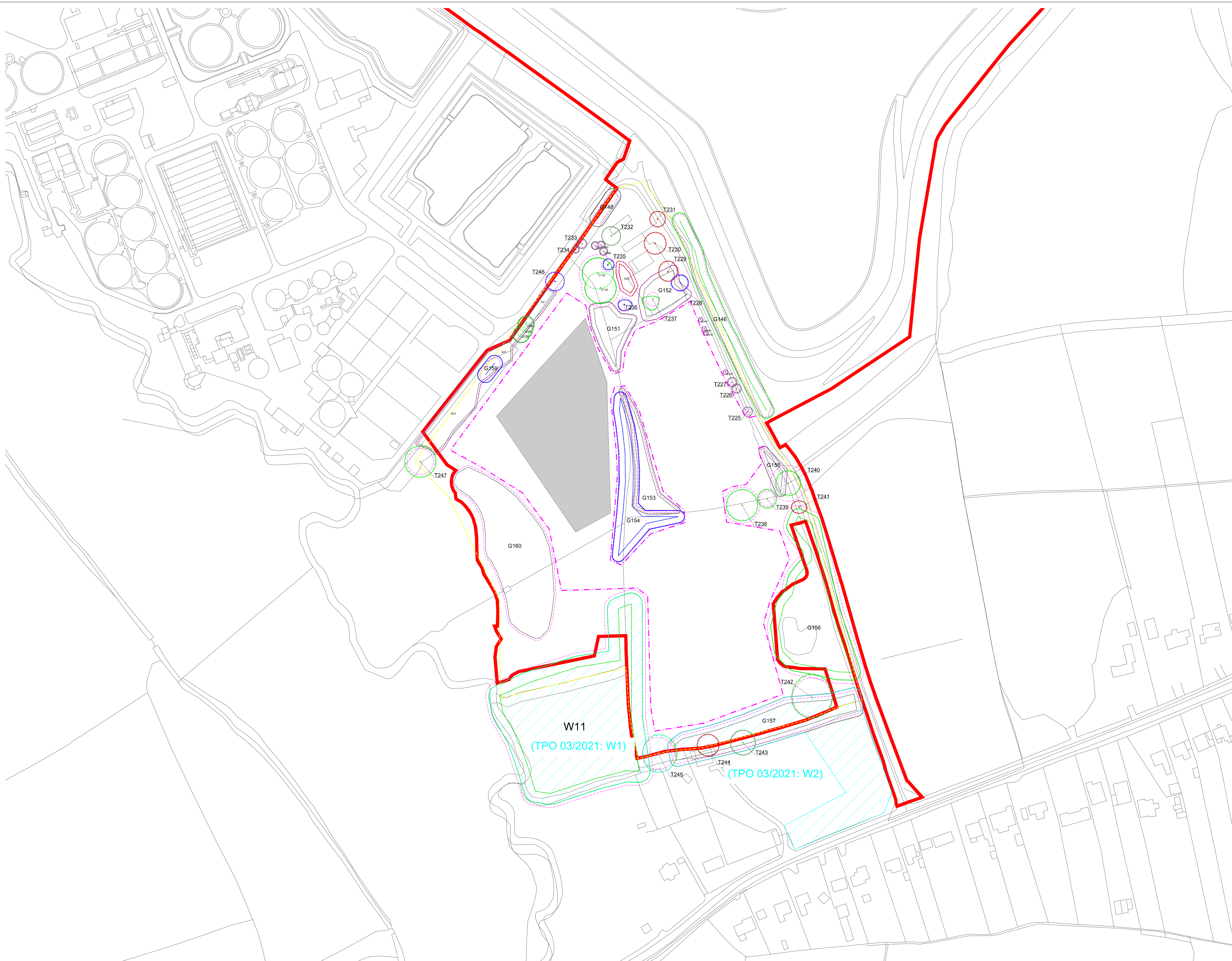

- Key**
- Site boundary
 - Survey boundary
 - Tree with numbered reference. Canopy extent and colour to match BS5837:2012 tree quality category as shown below.
 - = Tree details estimate (inaccessible tree)
 - = Tree in situ location
 - Tree group plotted with individual stem locations and numbered references. Canopy extents colour-coded to match BS5837:2012 tree quality category as shown below
 - Tree or vegetation group with numbered reference. Canopy extent colour-coded to match BS5837:2012 tree quality category as shown below and dashed line to show indicative stem line.
 - Hedge with numbered reference. Canopy extent colour-coded to match BS5837:2012 tree quality category as shown below and dashed line to show hedge centreline.
 - Woodland with numbered reference. Canopy extent colour-coded to match BS5837:2012 tree quality category as shown below and dashed line to show indicative tree line.
- BS 5837:2012 Tree Quality Categories - Table 1
- Category A - High quality
 - Category B - Moderate quality
 - Category C - Low quality
 - Category U - Unsuitable for retention
- Direction of first significant branch
 - Road protection area (RPA) Calculated in accordance with Section 4.6.1 BS5837:2012
 - Ancient woodland tree buffer (15m offset) (as per standing advice produced by Forestry England and Natural England)
 - Tree protected by Tree Preservation Order. Bracketted number relates to the TPO reference.
 - Designated Ancient Woodland (as per Natural England ancient woodland inventory, via open data publication)
 - Ancient Woodland tree buffer (15m offset) (as per standing advice produced by Forestry England and Natural England)
 - Projected tree loss required for construction of the Project (worst case scenario)
 - Indicative Scheme Layout
 - Indicative temporary protective fence line in accordance with Section 6.2 BS5837:2012. See below for example barriers.
 - Indicative secondary protective H15 Mesh fence line in accordance with Section 6.2 BS5837:2012. See below for example barriers.
 - Indicative vegetation protective fence line; Design and location to be agreed by local council during detail design.

- NOTES:**
- Refer to ES Appendix 6.10.1: Tree Survey Report and Ancillary
 - Some elements of this report have been removed from the ground and are not intended as a final technical specification.
 - The ground is represented with a topographic map as per BS5837:2012. It is in relation to design, demolition and construction.
 - Some elements of this report are not intended to be used as a final technical specification.
-

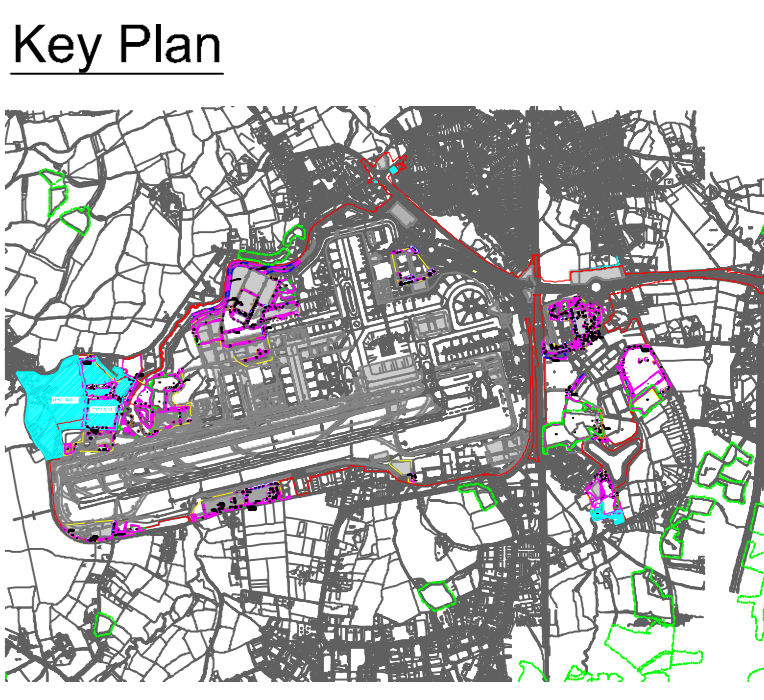

Environmental Statement

DRAWING TITLE
Airport Preliminary Tree Removal & Protection Plans
 Appendix 5.3.2 Annex 6
 Sheet 10 of 13

DATE
 June 2024

ORIENTATION	DRAWING NO.	REVISION
N	759	For ES Issue
	DRAWN BY	PIA / CHECKED BY
	RC	DC

SCALE @ A0
 0m 25m 50m

Reproduced from Ordnance Survey map with the permission of Ordnance Survey on behalf of the controller of Her Majesty's Stationery Office © Crown Copyright (2023). Licence number 6100031073, 10004892, 10004892.
 © Copyright 2023 Gatwick Airport Limited. No part of this drawing is to be reproduced without prior permission of Gatwick Airport Limited.

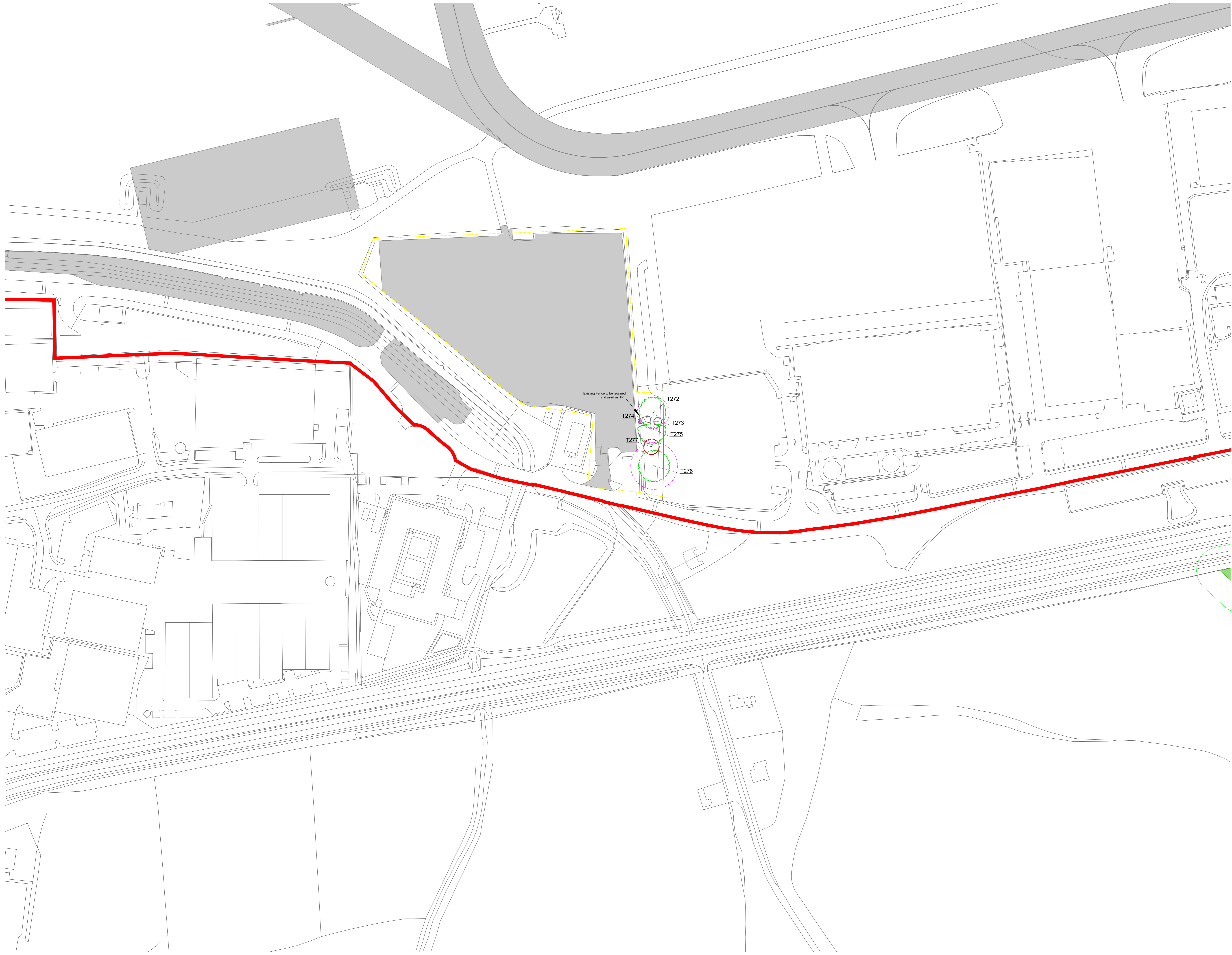

- Key**
- Site boundary
 - Survey boundary
 - Tree with numbered reference. Canopy spread and coloured B5537:2012 tree quality category as shown below.
 - = Tree details estimate (inaccessible tree)
 - = Tree in site location
 - Tree group plotted with individual stem locations and numbered references. Canopy extents coloured to match B5537:2012 tree quality category as shown below and dashed line to show indicative stem line.
 - Hedge with numbered reference. Canopy extents coloured to match B5537:2012 tree quality category as shown below and dashed line to show indicative stem line.
 - Woodland with numbered reference. Canopy extents coloured to match B5537:2012 tree quality category as shown below and dashed line to show indicative stem line.
- B5537:2012 Tree Quality Categories - Table 1**
- Category A - High quality
 - Category B - Moderate quality
 - Category C - Low quality
 - Category U - Unsuitable for retention
- Direction of first significant branch
 - Root protection area (RPA). Calculated in accordance with Section 4.6.
 - Victorian tree buffer (15 x 30m @) (as per standing advice produced by Forestry England and Natural England)
 - Tree protected by Tree Preservation Order. Bracketted number relates to the TPO reference.
 - Designated Ancient Woodland (as per Natural England ancient woodland inventory, via open data publication)
 - Ancient Woodland tree buffer (15m offset) (as per standing advice produced by Forestry England and Natural England)
 - Projected tree loss required for construction of the Project (worst case scenario)
 - Indicative Scheme Layout
 - Indicative temporary protective fence line in accordance with Section 6.2 - B5537:2012. See below for example barriers.
 - Indicative secondary protective H/V Mesh fence line in accordance with Section 6.2 - B5537:2012. See below for example barriers.
 - Indicative vegetation protective fence line; Design and location to be agreed by local council during detail design.

Existing Fence to be retained and used as TPF

T272
T273
T274
T275
T276

- NOTES:**
- Refer to ES Appendix A.10.1: Tree Survey Report and Ancillary Survey
 - Ground assessment for tree health
 - All trees are to be retained from the ground and are not intended as a M. artificial or natural
 - The ground is to be maintained in accordance with the B5537:2012 - "Trees in Relation to Design, Demolition and Construction"
 - Survey data is to be used to inform the design and construction of the Project
-

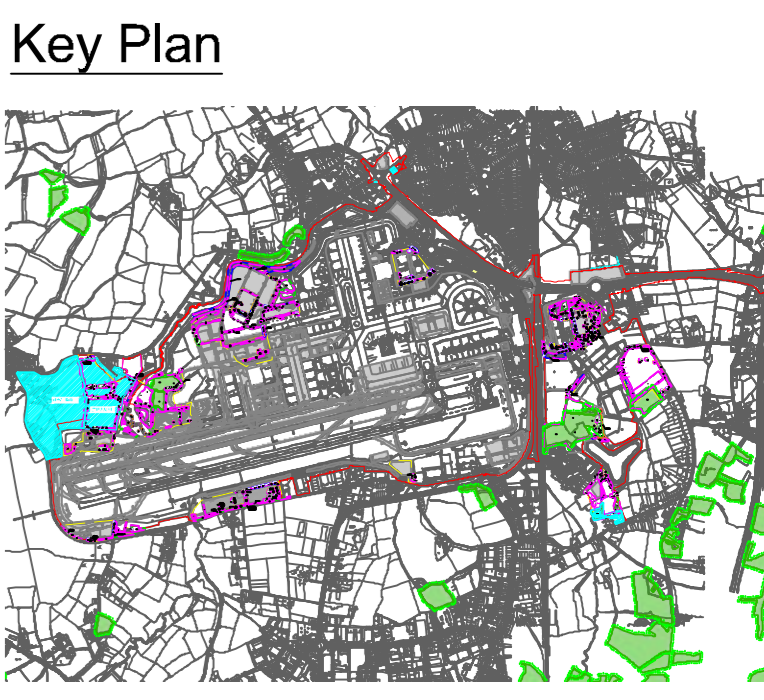

Environmental Statement

DRAWING TITLE
 Airport Preliminary Tree Removal & Protection Plans
 Appendix 5.3.2 Annex 6
 Sheet 11 of 13

DATE
 June 2024

ORIENTATION	DRAWING NO.	REVISION
N	760	For ES Issue
	RC	PIA / CHECKED BY DC

SCALE @ A0
 0m 25m 50m

Reproduced from Ordnance Survey map with the permission of Ordnance Survey on behalf of the controller of Her Majesty's Stationery Office © Crown Copyright (2023). Licence number 0100031673, 100048492.
 © Copyright 2023 Gatwick Airport Limited. No part of this drawing is to be reproduced without prior permission of Gatwick Airport Limited.



Key

- Site boundary
- Survey boundary
- Tree with numbered reference. Canopy spread and colour as BS5837:2012 tree quality category as shown below.
 - = Tree details estimate (impossible tree)
 - = Tree in off site location
- Tree group plotted with individual stem locations and numbered reference. Canopy extents colour-coded to match BS5837:2012 tree quality category as shown below and dashed line to show indicative stem line.
- Hedge with numbered reference. Canopy extents colour-coded to match BS5837:2012 tree quality category as shown below and dashed line to show hedge centreline.
- Woodland with numbered reference. Canopy extents colour-coded to match BS5837:2012 tree quality category as shown below and dashed line to show indicative tree line.

BS 5837:2012 Tree Quality Categories - Table 1

- Category A - High quality
- Category B - Moderate quality
- Category C - Low quality
- Category U - Unsuitable for retention

- Direction of first significant branch
- Road protection area (RPA). Calculated in accordance with Section 4.6.
- BS5837:2012
- (as per standing advice produced by Forestry England and Natural England)
- Tree protected by Tree Preservation Order. Bracketted number relates to the TPO reference.
- Designated Ancient Woodland (as per Natural England ancient woodland inventory, via open data publication)
- Ancient Woodland tree buffer (15m offset) (as per standing advice produced by Forestry England and Natural England)
- Protected tree less required for construction of the Project (worst case scenario)
- Indicative Scheme Layout
- Indicative temporary protective fence line in accordance with Section 6.2 - BS5837:2012. See below for example barriers.
- Indicative secondary protective H/V Mesh fence line in accordance with Section 6.2 - BS5837:2012. See below for example barriers.
- Indicative vegetation protective fence line. Design and location to be agreed by local council during detail design.

NOTES

- Refer to ES Appendix A.10.1: Tree Survey Report and Ancillary
- Survey details are for reference only.
- The location of any trees to be removed from the ground are not intended as a final arboreal instruction.
- The location of any trees to be retained are not intended as a final arboreal instruction.
- BS5837:2012 - "Trees in Relation to Design, Demolition and Construction"
- Survey details are for reference only and are not intended as a final arboreal instruction.

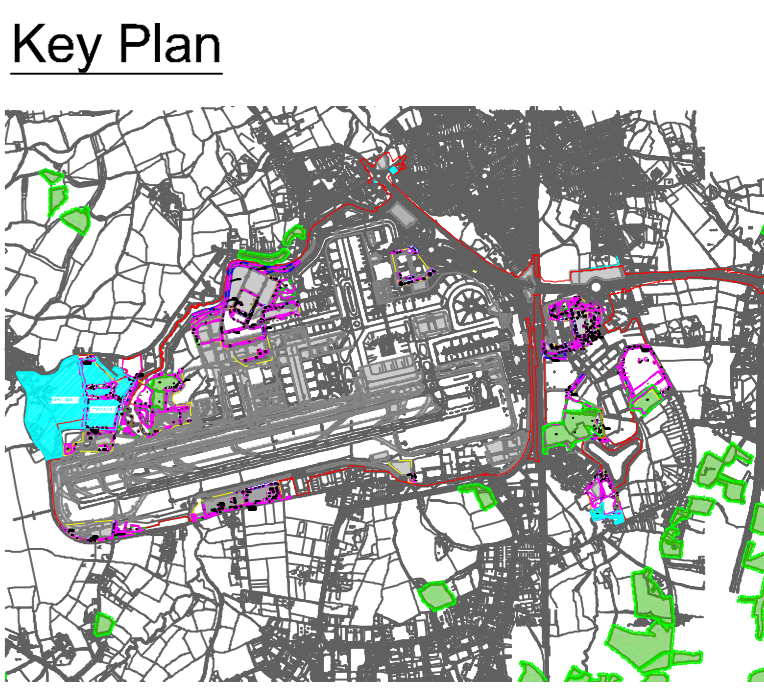

DOCUMENT

Environmental Statement

DRAWING TITLE

Airport Preliminary Tree Removal & Protection Plans
Appendix 5.3.2 Annex 6
Sheet 12 of 13

DATE

June 2024

ORIENTATION	DRAWING NO.	REVISION
N	761	For ES Issue
	DRAWN BY	PFA / CHECKED BY
	RC	DC

SCALE @ A0

0m 25m 50m

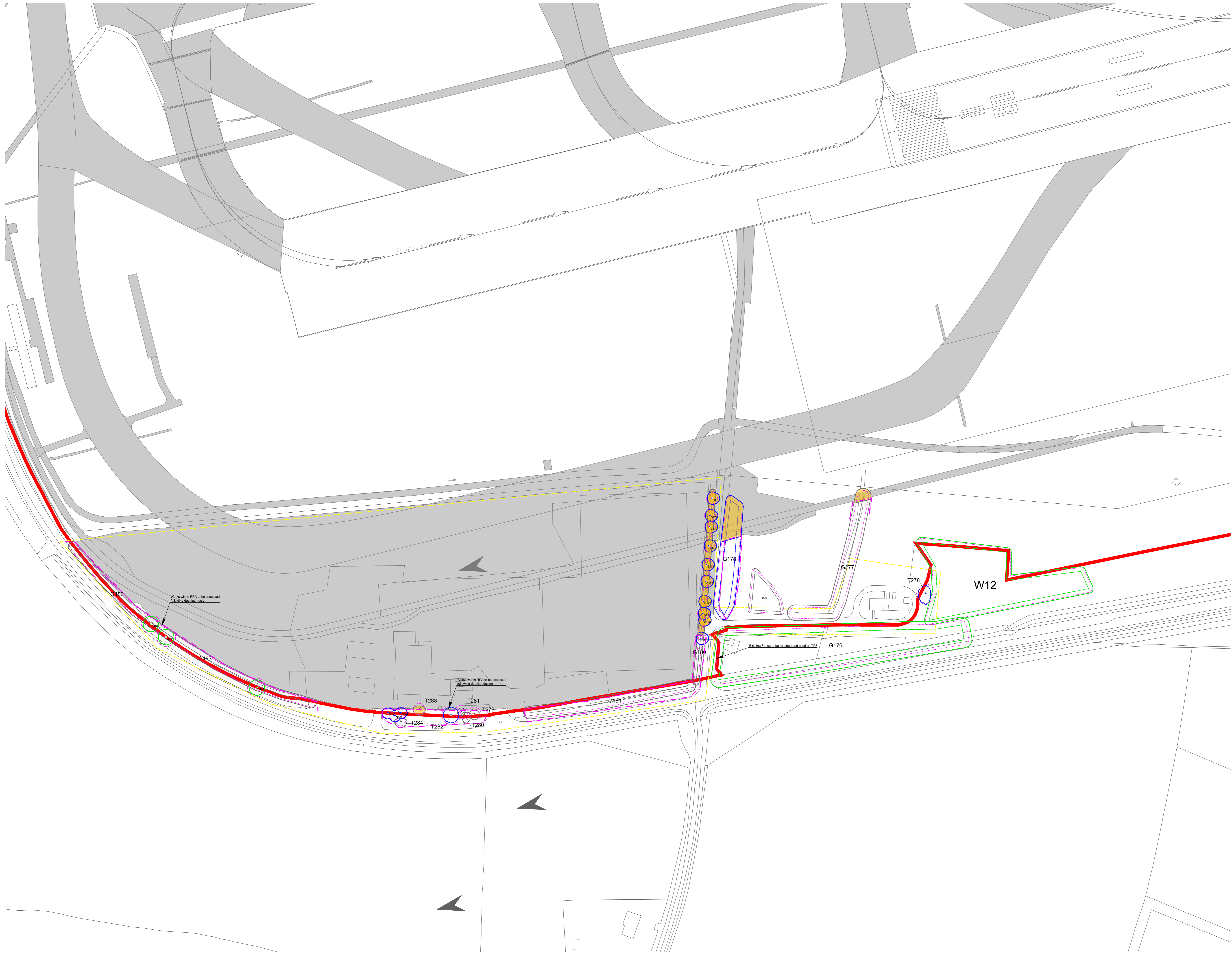

- ### Key
- Site boundary
 - Survey boundary
 - Tree with numbered reference
Canopy spread and coloured to match BS5837:2012 tree quality category as shown below
 - = Tree details estimate (measurable tree)
 - = Tree on off site location
 - Tree group plotted with individual stem locations and numbered reference. Canopy extents coloured to match BS5837:2012 tree quality category as shown below and dashed line to show indicative stem line.
 - Hedge with numbered reference
Canopy extents and coloured BS5837:2012 tree quality category as shown below and dashed line to show hedge contour.
 - Woodland with numbered reference
Canopy extents coloured to match BS5837:2012 tree quality category as shown below and dashed line to show indicative stem line.
- BS 5837:2012 Tree Quality Categories - Table 1
- Category A - High quality
 - Category B - Moderate quality
 - Category C - Low quality
 - Category U - Unsuitable for retention
- Direction of first significant branch
 - Root protection area (RPA)
Calculated in accordance with Section 4.6.6. BS5837:2012
 - Vegetation free buffer (15 x stem Ø)
(as per standing advice produced by Forestry England and Natural England)
 - Tree protected by Tree Preservation Order.
Bracketed number relates to the TPO reference.
 - Designated Ancient Woodland
(as per Natural England ancient woodland inventory, via open data publication)
 - Ancient Woodland tree buffer (15m offset)
(as per standing advice produced by Forestry England and Natural England)
 - Projected tree loss required for construction of the Project (worst case scenario)
 - Indicative Scheme Layout
 - Indicative temporary protective fence line in accordance with Section 6.2. BS5837:2012. See below for example barriers.
 - Indicative secondary protective H/W Mesh fencing in accordance with Section 6.2 - BS5837:2012. See below for example barriers.
 - Indicative vegetation protective fencing; Design and location to be agreed by local council during detail design.

NOTES:

- Refer to ES Appendix 6.10.1: Tree Survey Report and Ancillary
- Tree assessments for further details
- The plan shows the location of trees to be removed from the ground and is not intended as a final arboreal inventory.
- The plan shows the location of trees to be retained from the ground and is not intended as a final arboreal inventory.
- Some trees are shown as being retained from the ground and are not intended as a final arboreal inventory.
- Some trees are shown as being retained from the ground and are not intended as a final arboreal inventory.

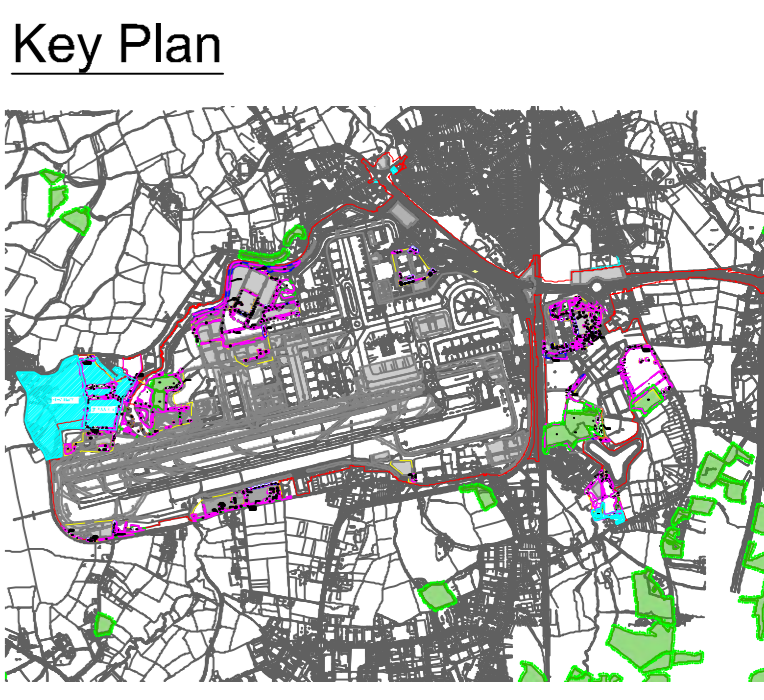
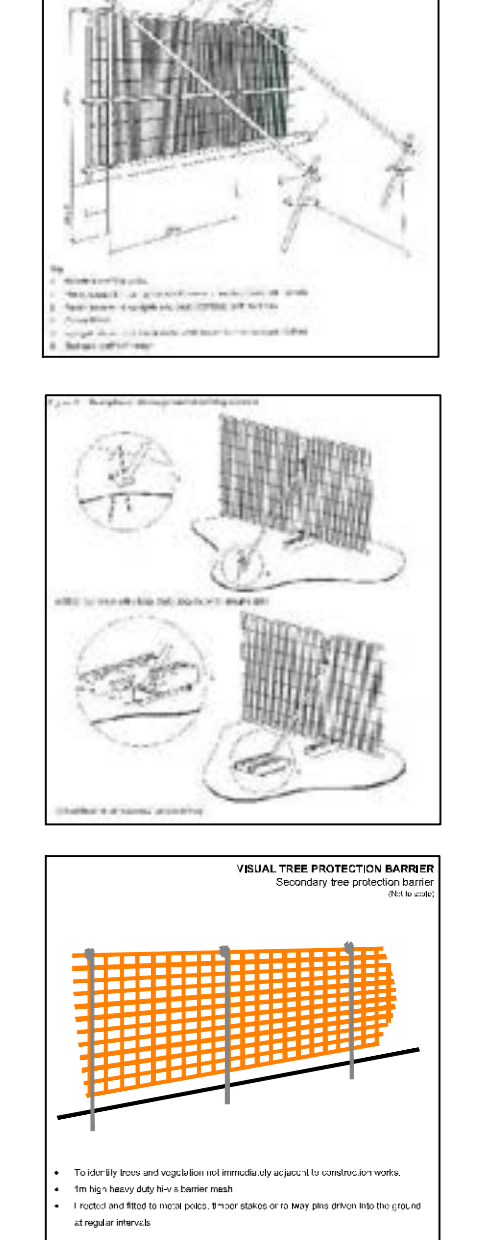

Environmental Statement

DRAWING TITLE
Airport Preliminary Tree Removal & Protection Plans
Appendix 5.3.2 Annex 6
Sheet 13 of 13

DATE
June 2024



ORIENTATION	DRAWING NO.	REVISION
N ↑	762	For ES Issue
	DRAWN BY RC	PIA / CHECKED BY DC

SCALE @ A0
0m 25m 50m

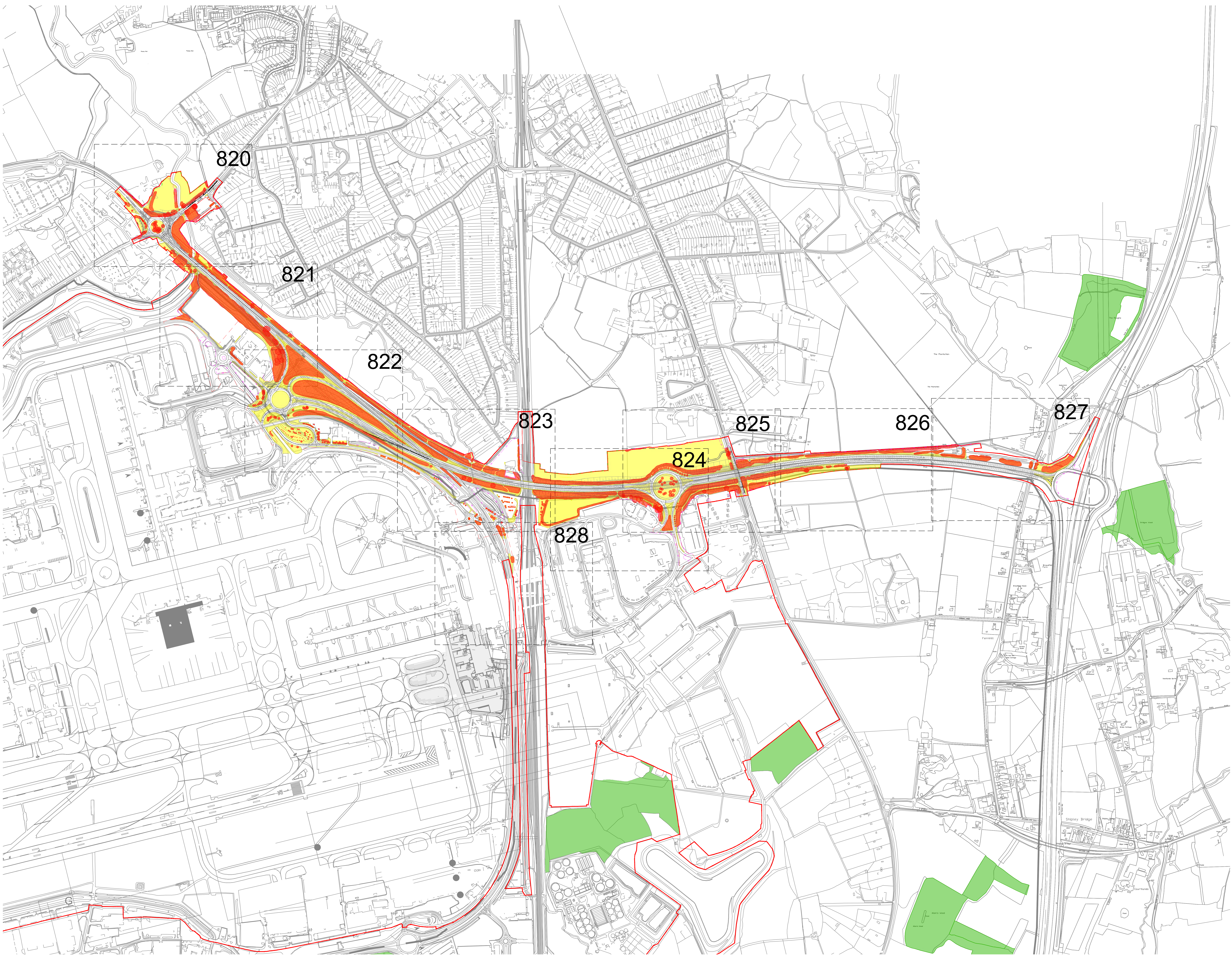
Appendix C
M23 & A23 Preliminary Vegetation Removal & Protection Plans

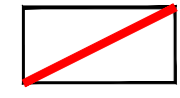
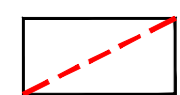
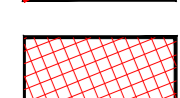
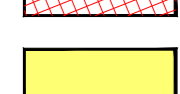
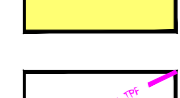

Legend

-  Site Boundary
-  Survey Boundary / Boundary of M23/A23 construction activity
-  Projected Tree Loss (Worst Case Scenario)
-  Projected Vegetation Loss (Worst Case Scenario)
-  Indicative temporary protective fence line in accordance with Section 6.2 - BS5937:2012. See below for example barriers.
-  Indicative vegetation protective fence line; Design and location to be agreed by local council during detail design.

NOTES:

- Refer to ES Appendix 6.10.1: Trees Survey Report and Arboricultural Impact Assessment for further details.
- Survey based on a visual inspection from the ground and is not intended as a full arboricultural inspection.
- Plan produced in accordance with recommendations set out in BS 5837:2012 - 'Trees in Relation to design, demolition and construction'.
- Survey based upon Aerial Photography and trees located by eye.

DOCUMENT
Environmental Statement

DRAWING TITLE
M23 & A23 Preliminary Vegetation Removal & Protection Plans Appendix 5.3.2 Annex 6 Overview





DATE
June 2024

N ▲	DRAWING NO. 829	REVISION For ES Issue
	DRAWN BY RC	PIA / CHECKED BY DC

SCALE @ A0
Custom Scale

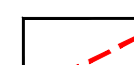
Reproduced from Ordnance Survey map with the permission of Ordnance Survey on behalf of the controller of Her Majesty's Stationery Office. © Crown Copyright (2023). Licence number 0100031073. 100048492.
© Copyright 2023 Gatwick Airport Limited. No part of this drawing is to be reproduced without prior permission of Gatwick Airport Limited.

Legend

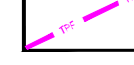
-  Site Boundary
-  Survey Boundary / Boundary of M23/A23 construction activity
-  Projected Tree Loss (Worst Case Scenario)
-  Projected Vegetation Loss (Worst Case Scenario)
-  Indicative temporary protective fence line in accordance with Section 6.2 - BS5837:2012. See below for example barriers.
-  Indicative vegetation protective fence line; Design and location to be agreed by local council during detail design.

NOTES:

- Refer to ES Appendix A 10.1: Tree Survey Report and Arboricultural Impact Assessment for further details.
- Survey based on a visual inspection from the ground and is not intended as a full arboricultural inspection.
- Plan produced in accordance with recommendations set out in BS 5837:2012 - 'Trees in Relation to design, demolition and construction'.
- Survey based upon Aerial Photography and trees located by eye.

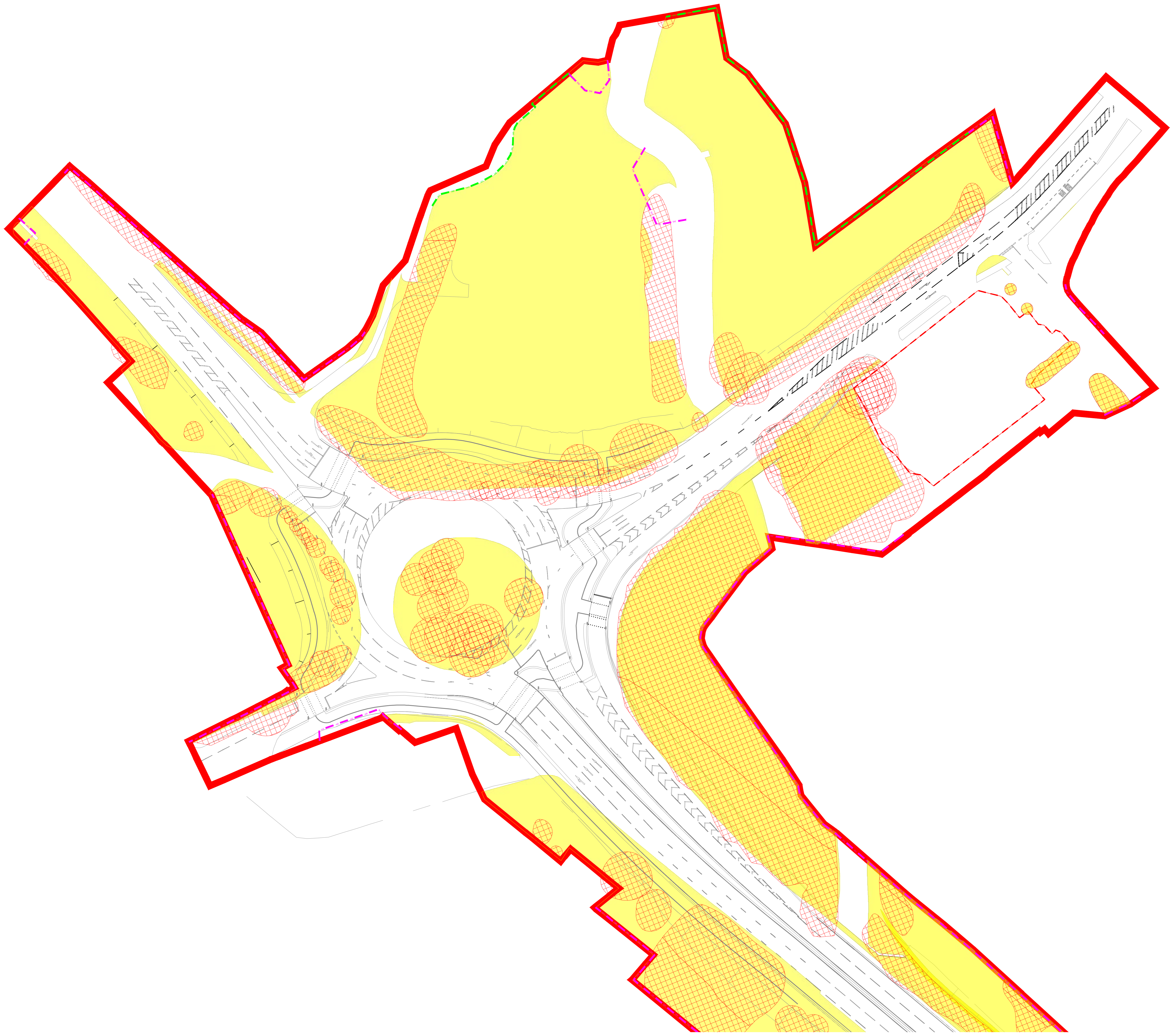

Key Plan

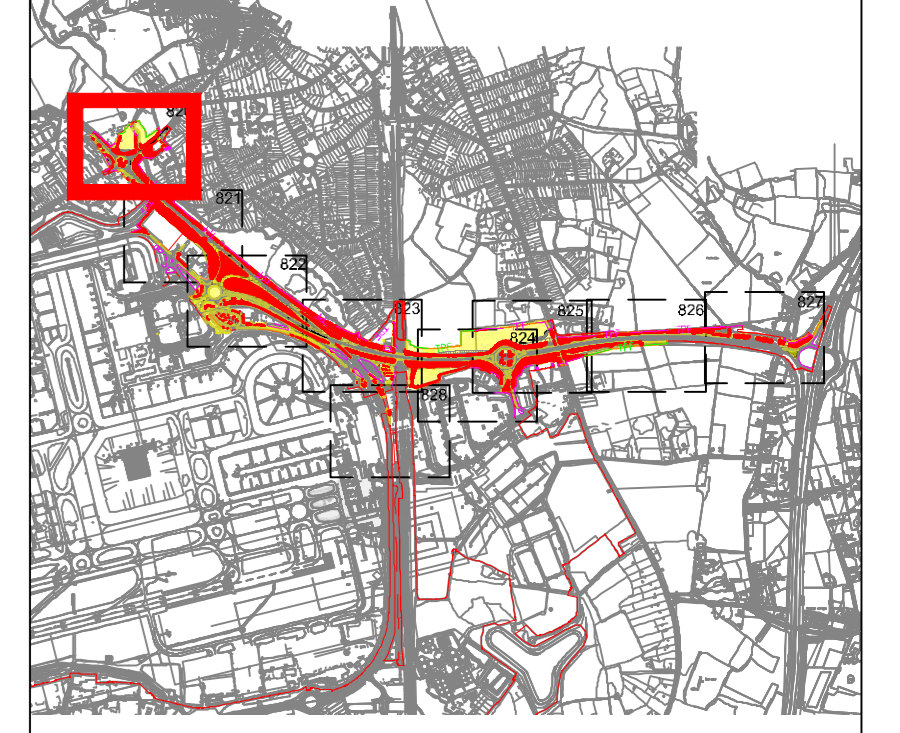

DOCUMENT
Environmental Statement

DRAWING TITLE
M23 & A23 Preliminary Vegetation Removal & Protection Plans Appendix 5.3.2 Annex 6 Sheet 1 of 9

DATE
June 2024

ORIENTATION N 	DRAWING NO. 820	REVISION For ES Issue
	DRAWN BY RC	PIA / CHECKED BY DC

SCALE @ A0

Reproduced from Ordnance Survey map with the permission of Ordnance Survey on behalf of the controller of Her Majesty's Stationery Office © Crown Copyright (2023). Licence number 0100031073, 10001998, 100048492.
© Copyright 2023 Gatwick Airport Limited. No part of this drawing is to be reproduced without prior permission of Gatwick Airport Limited.